

DATASHEET FOR EC3-14 PIN EDGE-CONNECT (TM) CABLE

REV	DESCRIPTION	DATE	REV BY
A	INITIAL RELEASE	12/13/2023	B. HOPKINS

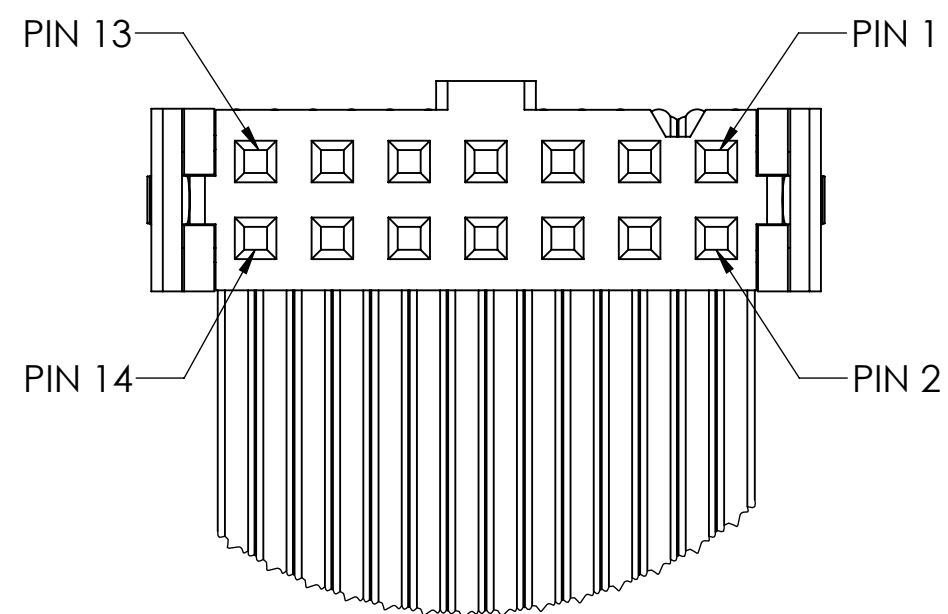

DETAIL C
SCALE 4:1

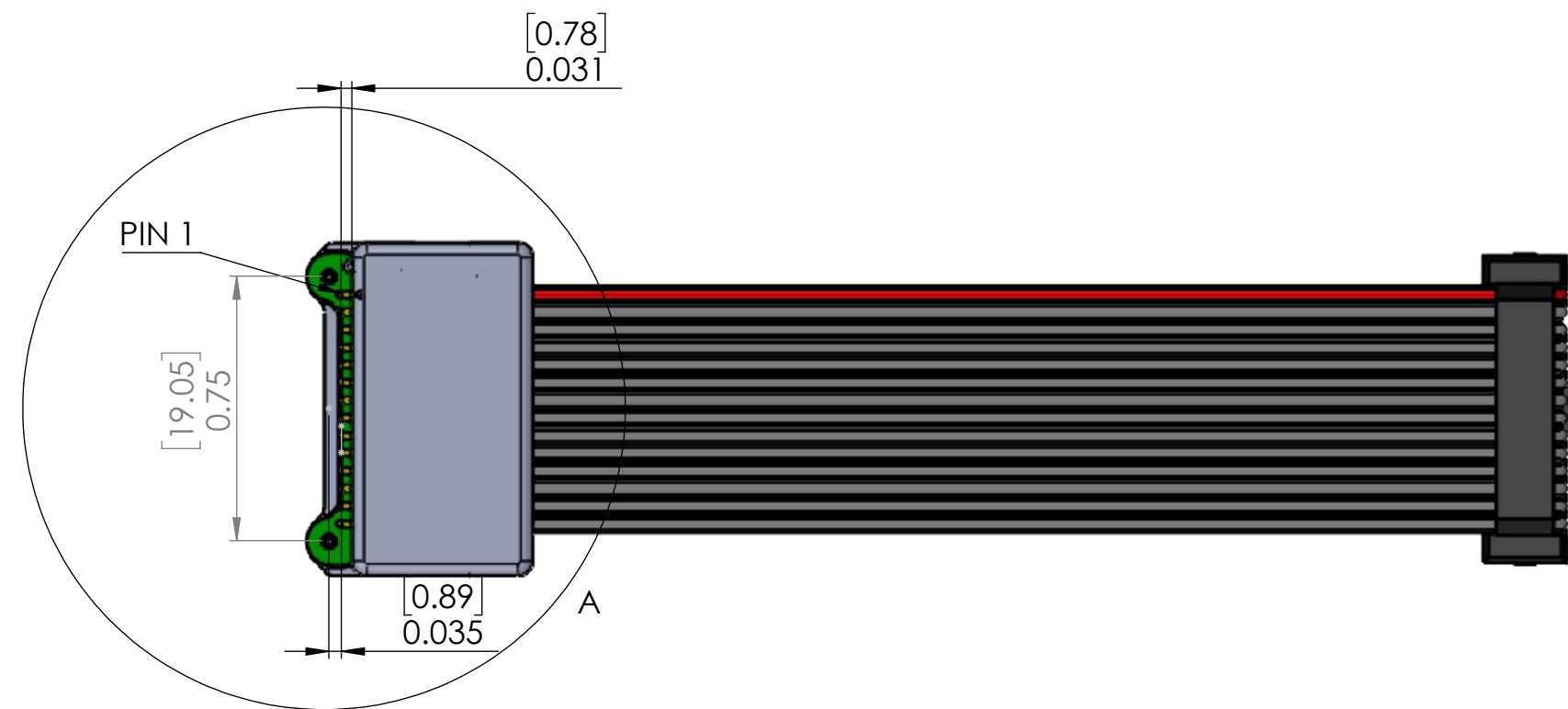
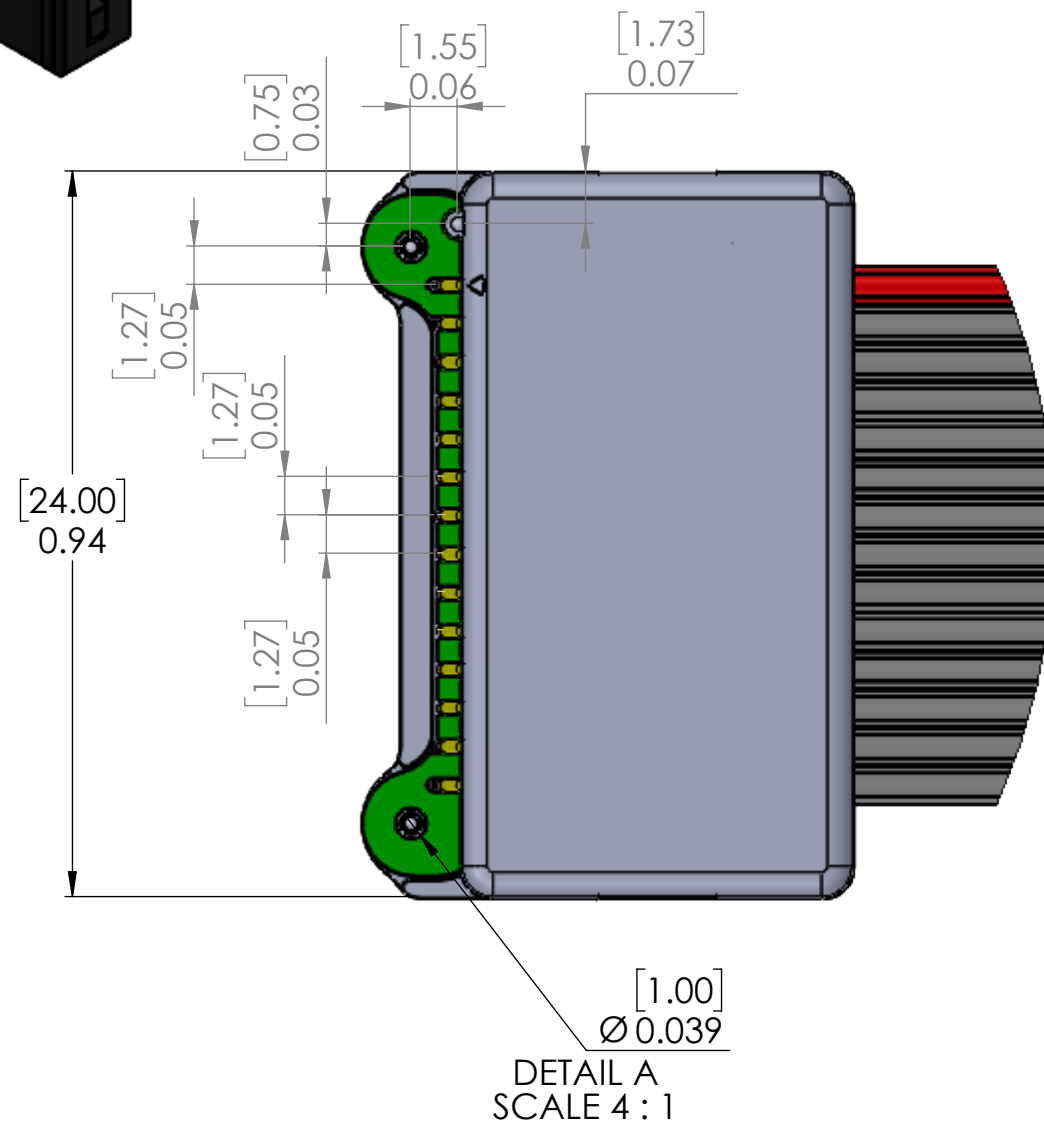
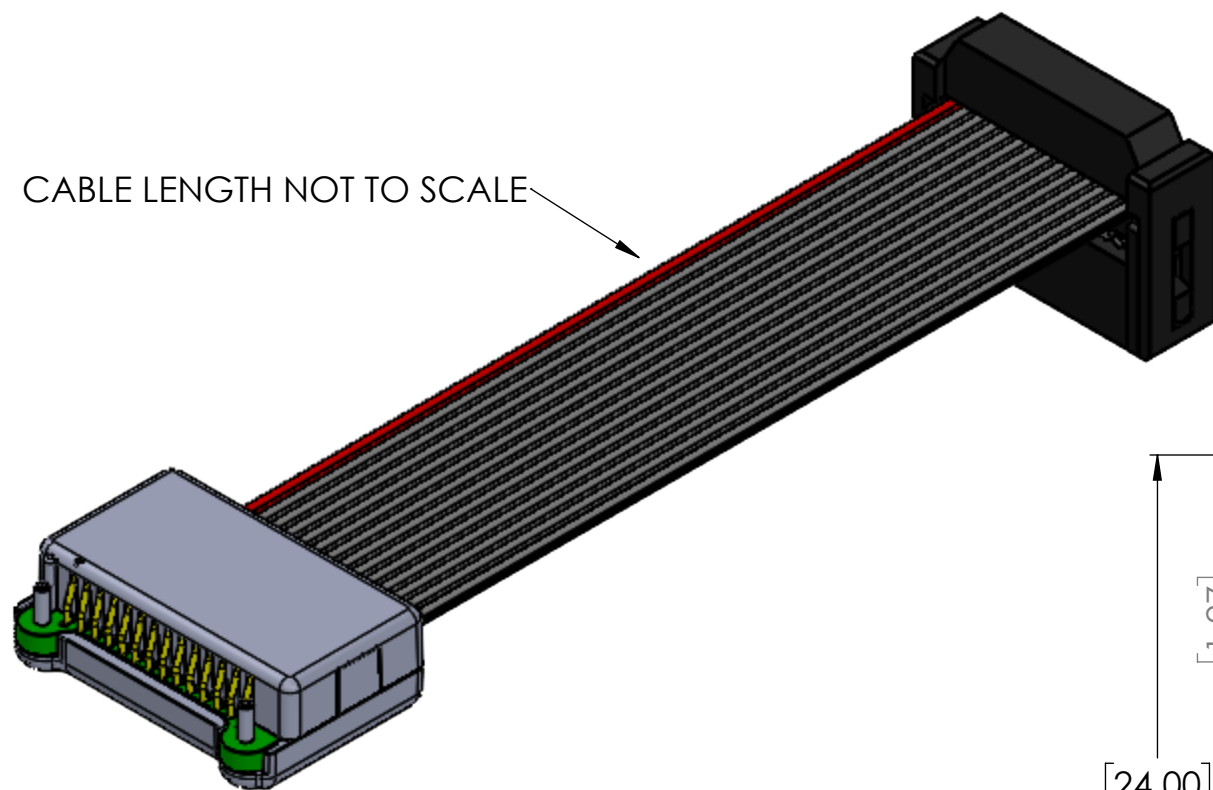
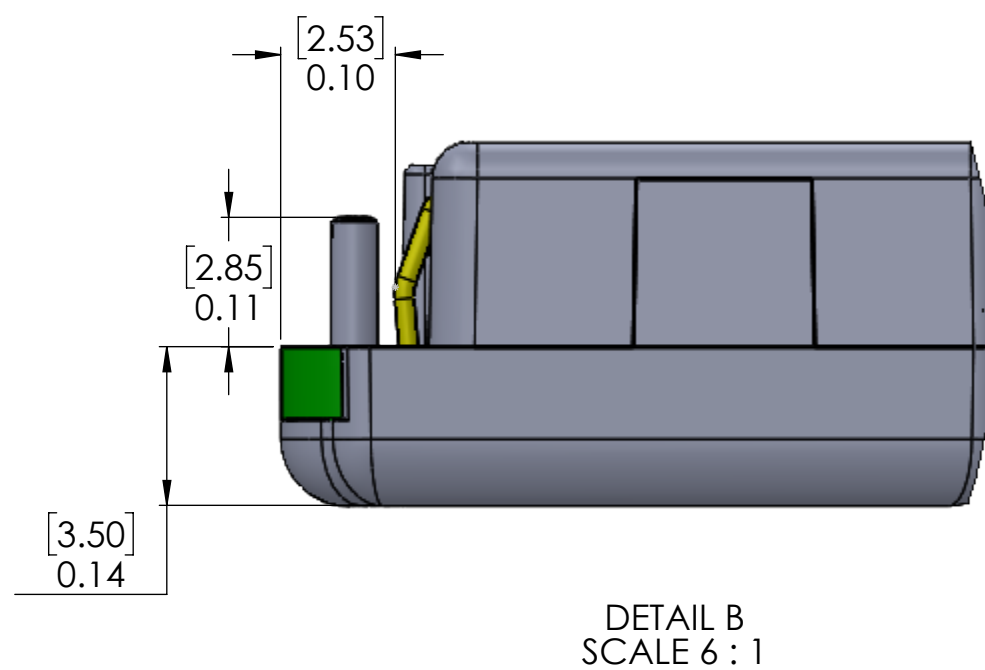

DETAIL B
SCALE 6:1

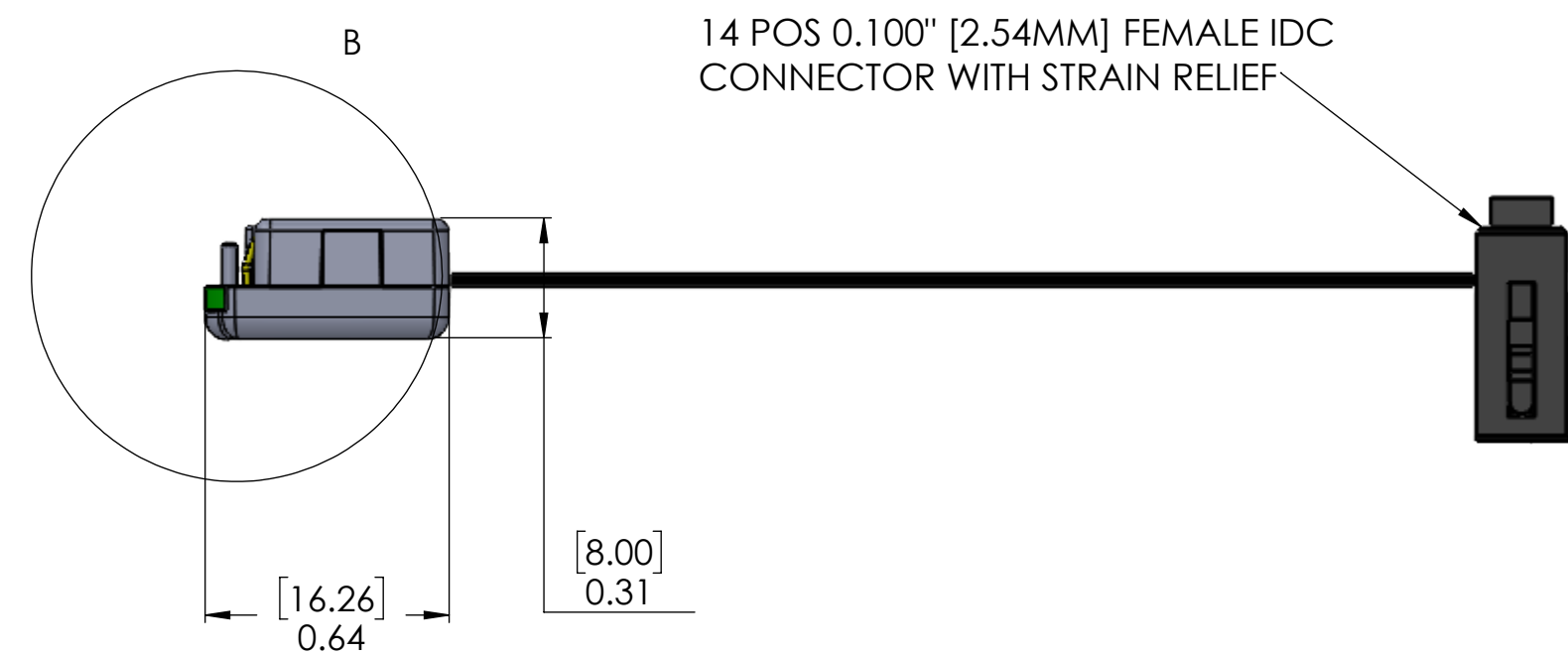

14 POS 0.100" [2.54MM] FEMALE IDC
CONNECTOR WITH STRAIN RELIEF

SEE PCB LAYOUT DETAILS ON SHEET 2
FOR MATING BOARD FOOTPRINT.
DIMENSIONS ARE SUBJECT TO CHANGE.

SIZE	PART NO.	DESC.	REV
A	ECV3-14-IDC	EDGE-CONNECT, EC3 14 PIN	A
DO NOT SCALE		www.TAG-CONNECT.com	SHEET 1 OF 2

4

3

2

1

Thinner PCB Thicknesses
may be used, but must be
tested by the end user.

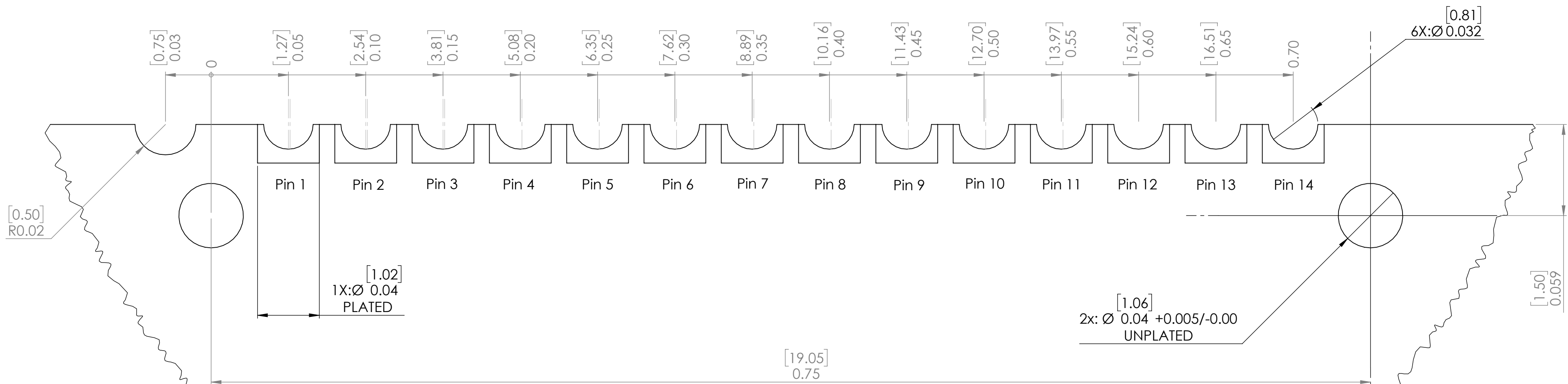
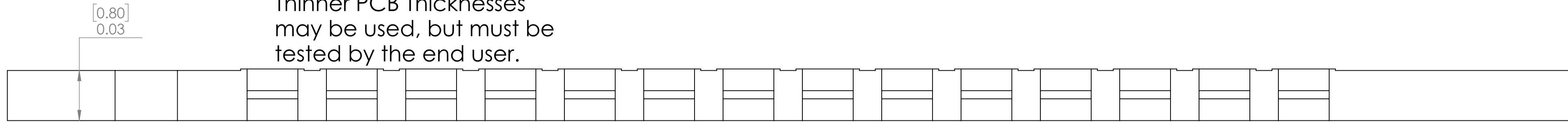

PCB BOARD

DETAIL D
SCALE 20 : 1

Note:
All holes need to be placed within
0.002 inches [0.005mm] from the
center pin location.

All hole diameters need to be
made within 0.005 inches [0.1mm] of
the nominal hole.

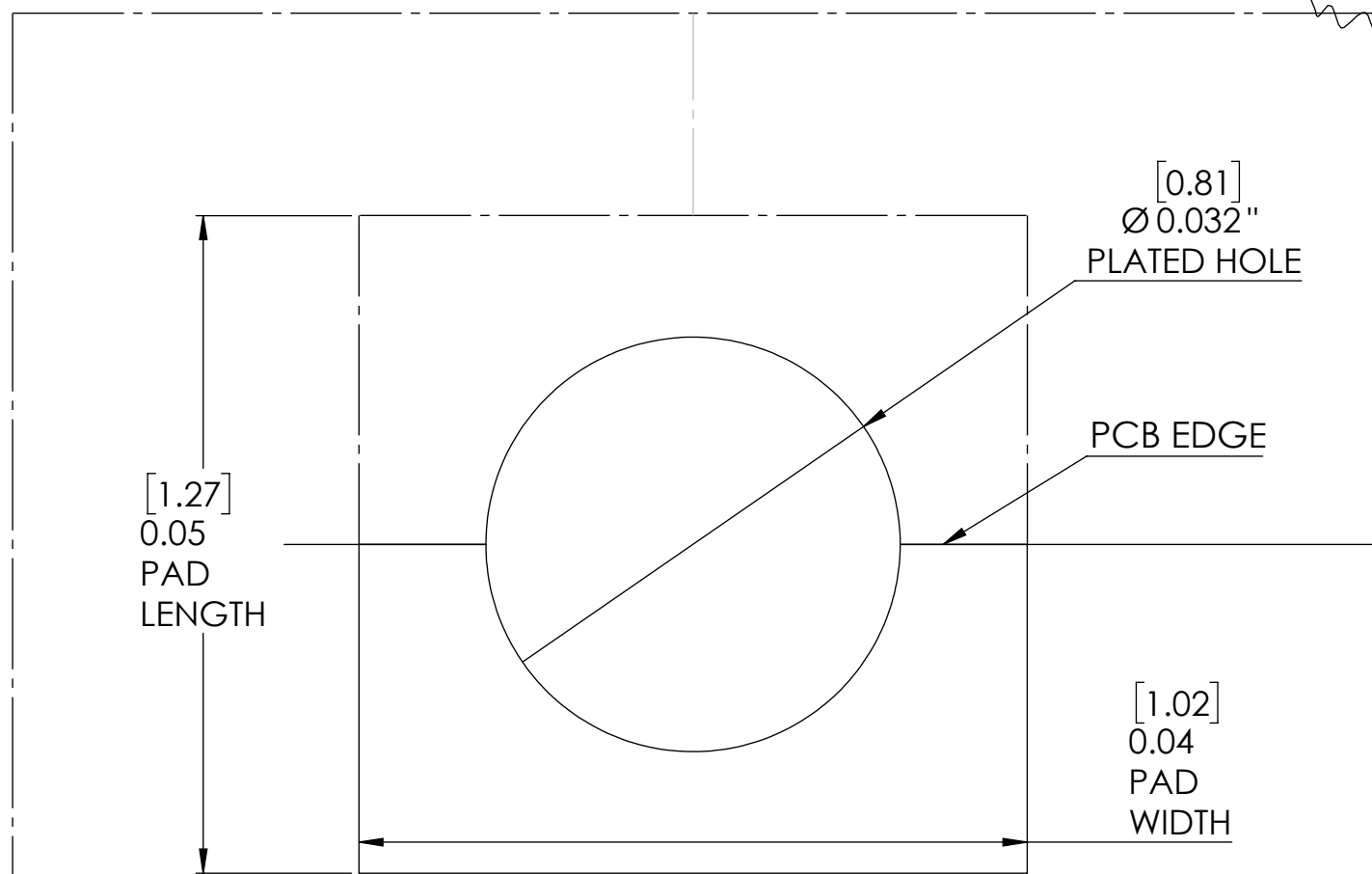

PCB BOARD

EC3-14 MATING PCB FOOTPRINT

SIZE	PART NO.	DESC.	REV
A	EC3-14	EDGE-CONNECT, EC3 14 PIN	A
DO NOT SCALE		www.TAG-CONNECT.com	SHEET 2 OF 2

4

3

2

1